

This drawing remains Steelwrist property and should not be copied without our written allowance. Nor is permitted to show or give this to a third person. Contravention will be prosecuted with the support of existing law.

2	2	Side Plate S40	202691
1	2	Shaft S40	200350
Item	Qty	Description	Note
Material		Proj. Method E	Scale 1:2
Surface Treatment		General surf. 3,2/roughn.	Drawing size A3
Material description, dimension		Weight (kg) 8.87	All dimensions metric Sharp edges broken 0.2-0.3 Hole edge radius: max 0.3 H11/h11
Description		S40 Bucket Adaptor	
Drawn by cri		Approved by	Date 2008-03-07
Drawing number 202690		Revision A	Sheet 1(1)

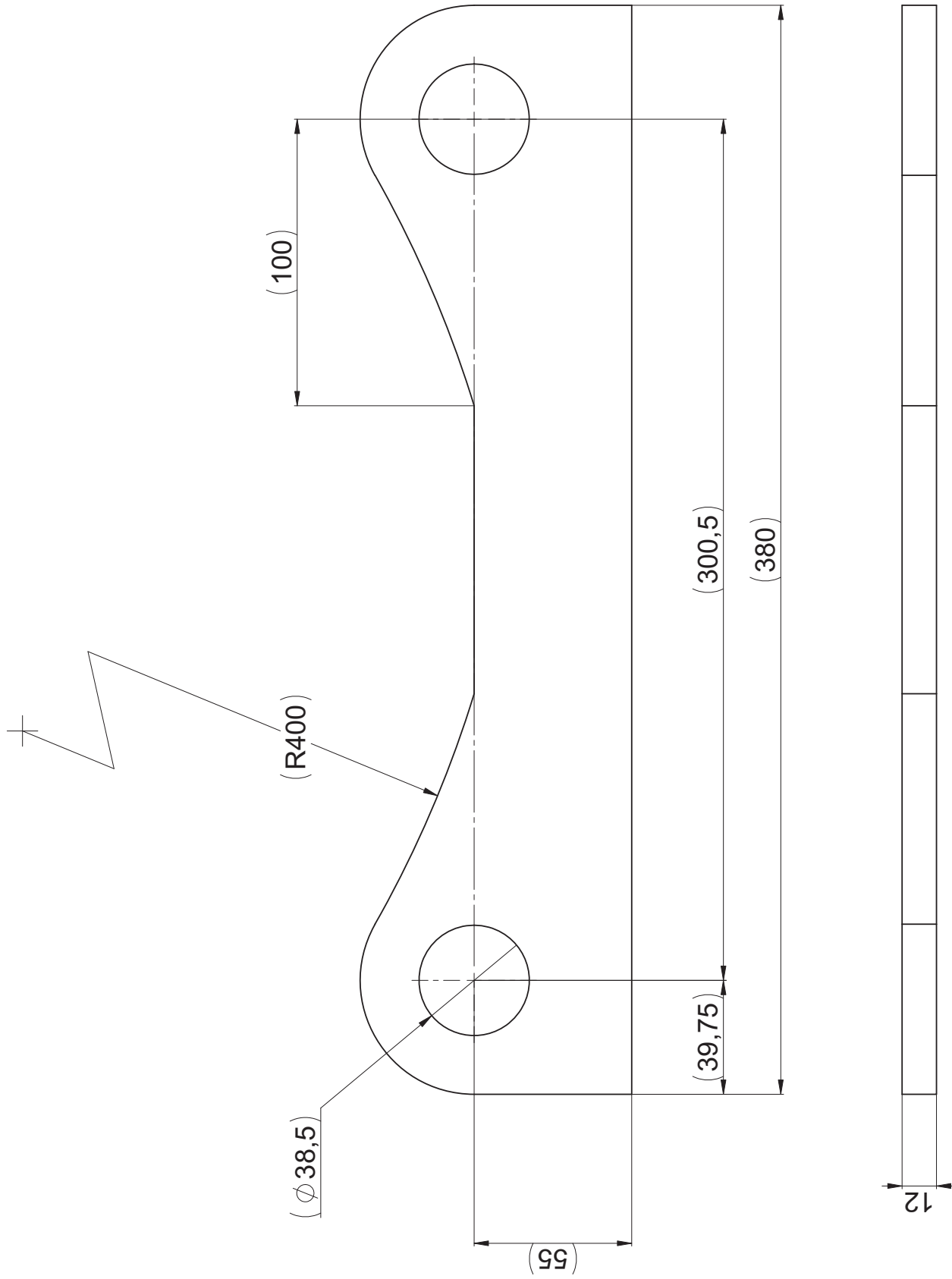

This drawing remains Steelnwrist property and should not be copied without our written allowance. Nor is permitted to show or give this to a third person. Contravention will be prosecuted with the support of existing law.

Material	Weldox700	Prog. Method E	Scale	1:1	General tolerances
Surface Treatment		General surf. 3,2 roughness	Drawing size	A2	ISO 2768-mK ISO 2768-2 K
Material description, dimension	l=12	All dimensions metric	Weight	2.34	ISO 13920 CG ISO 286-1: H11/h11
Description		Side Plate S40			
Drawn by	ctf	Approved by	Drawn date	2008-03-07	Drawing number
			Revision	202691	Sheet
			Revision	A	1(2)

This drawing remains Steelwrist property and should not be copied without our written allowance. Nor it is permitted to show or give this to a third person. Contravention will be prosecuted with the support of existing law.

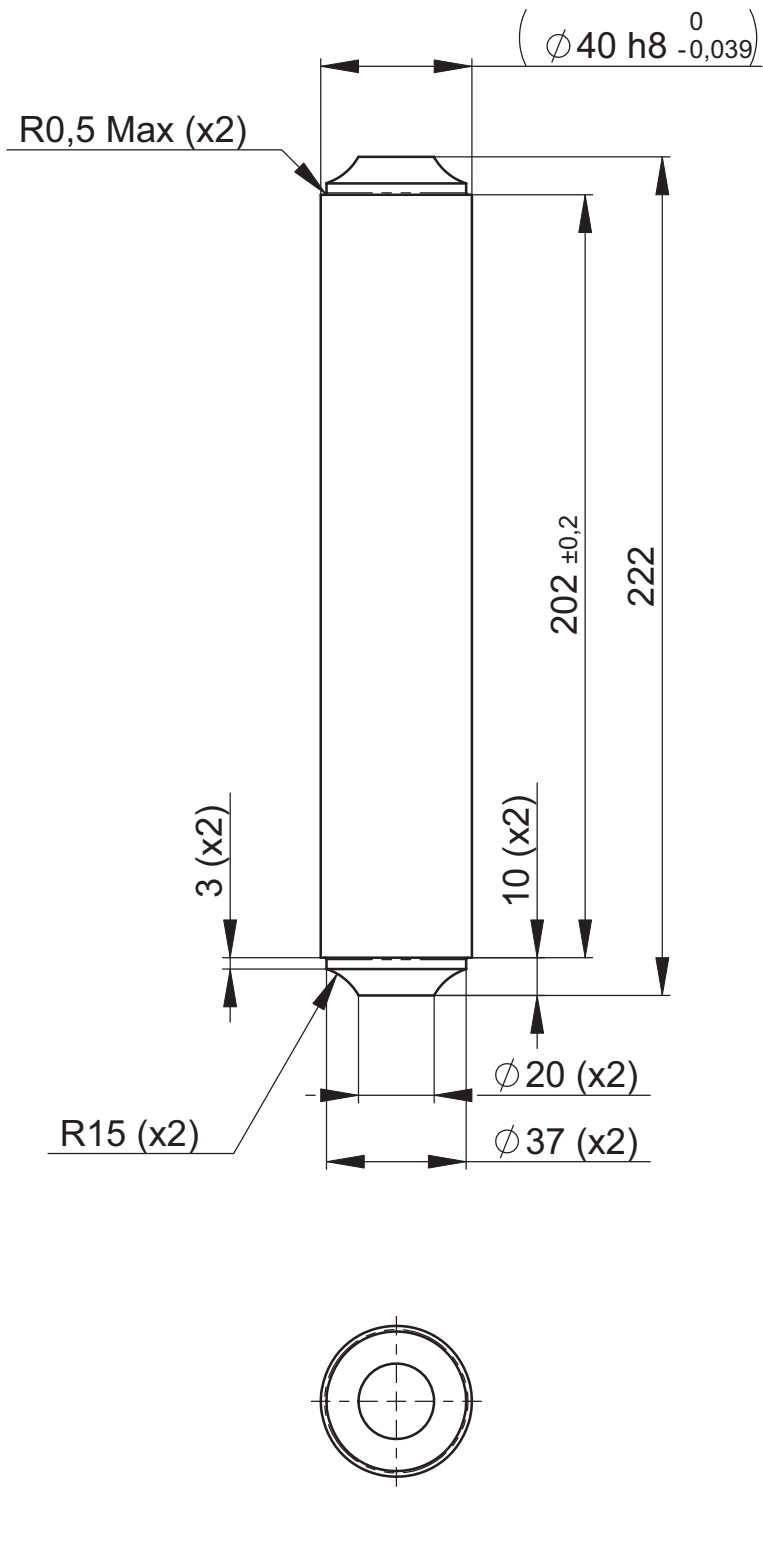

Material S355J2 (SS2142)		Proj. Method E 	Scale 1:2	General tolerances ISO 2768-mK	
Surface Treatment		General surf. roughn. $3,2/\sqrt{\quad}$	Drawing size A4	ISO 2768-2 K	
Material description, dimension $\phi 45$ h8 grinded shaft		Weight (kg) 2.09	All dimensions metric Sharp edges broken 0.2-0.3 Hole edge radius: max 0.3		ISO 13920 CG
 STEELWRIST 		Description Shaft S40			
		Drawn by cri	Approved by cri	Date 2007-03-02	Drawing number 200350